

# INSTALLATION

## TOOLS REQUIRED

- Saw
- Pop rivet gun
- Silicone
- PVC solvent cement (clear)
- Screwdriver
- Drill (if using masonry wall)

## STRAIGHT CONNECTION (NO EAVES)



**1** Cut hole in gutter at appropriate position above stormwater outlet using "gutter pop" as a template.

If a 50x100mm rectangular fitting exists, just connect the 50x100mm adaptor to the end of the downpipe when installing.

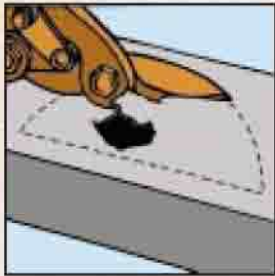

**2** Place "gutter pop" into hole and drill three holes. Glue "gutter pop" in place with silicone sealant and secure with pop rivets.

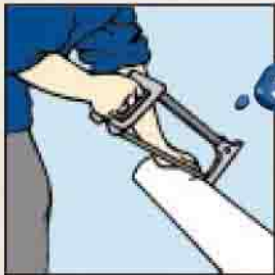

**3** Measure required length of "RAINTECH downpipe". Then cut to length, ensuring all cuts are square and cleaned properly.

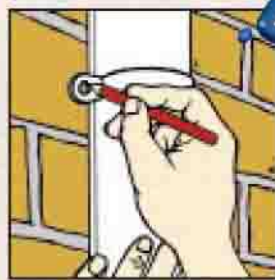

**4** The system allows for two fixing options. Choose the one that best suits your requirements.

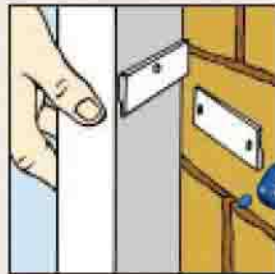
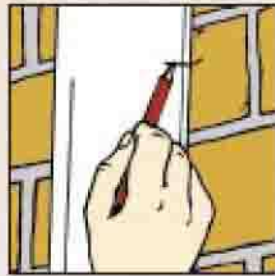
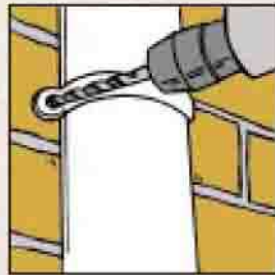

**OPTION 1: FIXING WITH EXTERNAL STRAPS**  
Using the "external wall strap" as a template, mark position of fixing holes with a pencil. Drill two 5mm holes in your wall. Fit "external wall strap" over downpipe and install with screws.

**OPTION 2: FIXING WITH CONCEALED BRACKETS**  
With "concealed brackets", mark fixing point on rear of downpipe bracket (piece with no holes) with sharp lip facing down and outwards onto the downpipe. Drill and fix with pop rivet. Fix the wall bracket (piece with holes) with the sharp lip facing up and outwards onto wall. Finally place downpipe flush to wall. Line up the brackets and slide pipe down until each bracket connects together.

**5** Finally, apply silicone to inside top of downpipe (to allow for expansion & contraction) and slide onto gutter pop or 50x100mm adaptor. Similarly, apply silicone to 90mm waste adaptor when using.

All other fittings should be joined using clear PVC solvent cement.

## UNDER EAVE CONNECTION



**1** Follow step 1 as for the straight connection.

**2** Cut short length of "RAINTECH downpipe" to outlet to the 95° external elbow to the height of fascia.

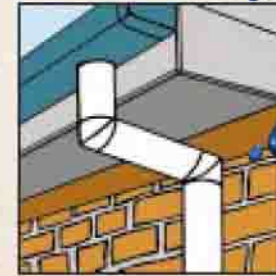

**3** Cut another length of "RAINTECH downpipe" and connect the "95° internal elbow" at wall.

**4** Fix to wall (repeat steps 3, 4 & 5 for straight connection)

## OFFSET INSTALLATION

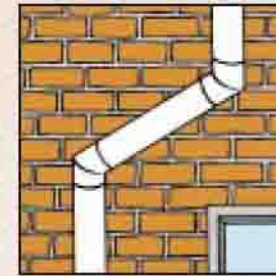

Use "30° flat offset" and follow steps 3, 4 & 5, cutting downpipe to appropriate lengths.

